

# DATA SHEET PTB 3800

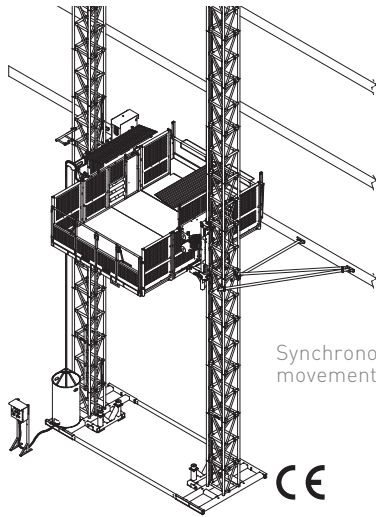

Synchronous mast movement



Dual operation mode:  
persons – loads



Double shaft parachute with auto-recovery system

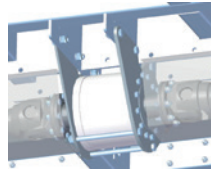

Platform assembly options

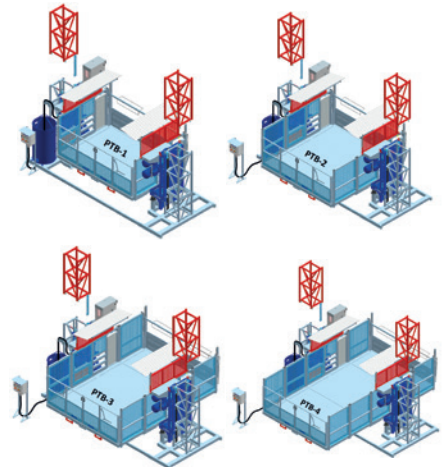

CPU and automatic floor management



Platform general dimensions

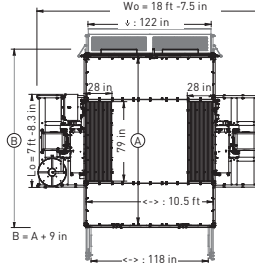

## TECHNICAL FEATURES

	PTB 3800-2V	PTB 3800-1V
	<b>Cage dimensions (W x L)</b> 10.5 x 6.9 in 10.5 x 10.5 in 10.5 x 13.8 in 10.5 x 17.4 in	<b>Maximum capacity</b> 8,400 lb - (7pax) 7,700 lb - (7pax) 7,050 lb - (7pax) 6,400 lb - (7pax)
<b>PLATFORM MODEL</b>	PTB 3800-2V	PTB 3800-1V
<b>Vertical speed</b>	40 ÷ 72 ft/min	66 ft/min
<b>Motor control</b>	FREQUENCY CONVERTER	DIRECT
<b>Maximum height (*)</b>	820 ft (*)	
<b>Anchorage each (max.)</b>	40 ft	
<b>Height over last anchorage</b>	10 ft	
<b>First anchorage height</b>	20 ft	
<b>Loading height-to-ground with cable bin with cable trolley</b>	2.6 ft 3.9 ft	
<b>Transport dimensions (LxWxH)</b>	7.7 x 18.6 x 7.9 in	
<b>Regulations reference</b>	ANSI A92.10	

## ELECTRICAL DATA

	PTB-3800-2V	PTB-3800-1V	
	50/60 Hz	50 Hz	60 Hz
<b>Motor power</b>	4 x 5.5 kW	4 x 5.5 kW	4 x 6.6 kW
<b>Input power connection</b>	380÷460 V – 50/60 Hz	400 V – 50 Hz	440 V – 60 Hz
<b>Power consumption</b>	30 kW	26 kW	
<b>Nominal current</b>	50 A	48 A	
<b>Supply power</b>	50 kVA	40 kVA	
<b>Overload protection</b>	3 x 63 A		
<b>Differential protection</b>	63 A		
<b>Calibration</b>	300 mA		
<b>Sensitivity</b>	48 V		
<b>Control voltage</b>	230 V – 50/60 Hz 1200 W		
<b>Auxiliar handtools socket</b>	4 x 6 AWG		
<b>Cable section</b>	4 x 6 AWG		

**MAST SECTION**

**Square mast**  
Length: 58,6 in  
Weight:  
1Rack::251 lb  
2Rack: 295 lb

**Mast compatibility: [see p.20]**  
Mast climber: PEC 130 / PEC 150  
Material hoist: MC 2000  
Passengers & material hoist: EDC 2000

(\*) h < 500 ft →Standard mast, / h > 500 ft →Reinforced mast.

## SAFETY DEVICES INCLUDED AND OPTIONS

	INCLUDED	OPTION
<b>GENERALS</b>		
Gearmotors with electromechanical brake	✓	
Overspeed parachute with auto-recovery system	✓	
Emergency lowering lever	✓	
Cage doors with automatic side protection	✓	
Landing doors with mechanical / electrical interlock		✓
Base enclosure with electrical interlock		✓
Hoist control display with signaling LEDs:	✓	
- Cage / landing door open		
- End of mast		
- Upper/lower endtrack		
- Aux. Crane interfering		
- Fault on brake of motor		
- Last 2 m zone		
- Overspeed parachute		
- Cage overload		
- Motor overheat fault		
- Hoist free / busy		
Automatic floor management	✓	
Buffers at the ground base	✓	
Falling object protection guard [removable]	✓	
Hoist control CPU, with event log	✓	
Upper/lower endtrack limit switch	✓	
Safety endtrack limit switch	✓	
Overload detection device	✓	
Mast presence switch	✓	
Last mast without rack	✓	
Aux. platform for mast and anchorage assembly	✓	
Aux. crane and equipment for mast assembly		✓
Automatic greasing system for rack and pinion		✓
Cage floor of non-slipping galvanized steel	✓	
Movement warning horn (LAST 2 m)	✓	PTB 2V
Phase control	✓	
Emergency stop	✓	
Landing levels call system		✓
Parachute test remote control		✓
Automatic greaser		✓